

Typ Z²

Typ Z²-HD

Axes et réglage de la largeur / Axles and width adjustment / Achsen und Breitereinstellung

Typ Z²

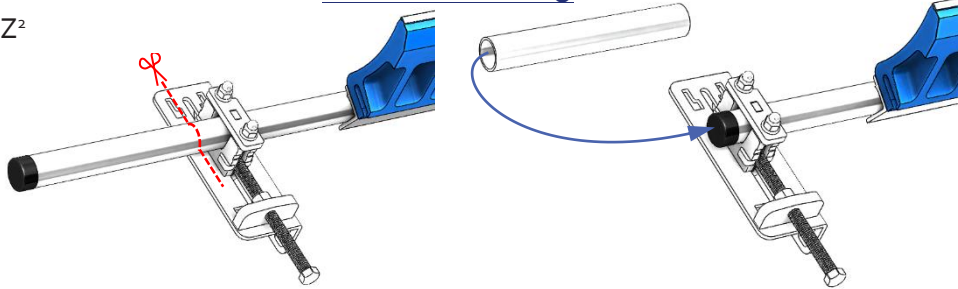

BT / BW / BB < 1600

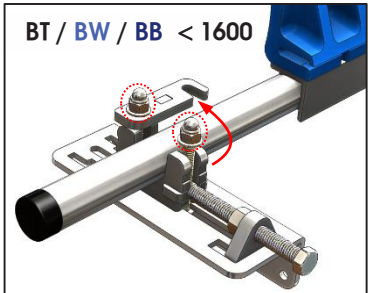

Typ Z²-HD

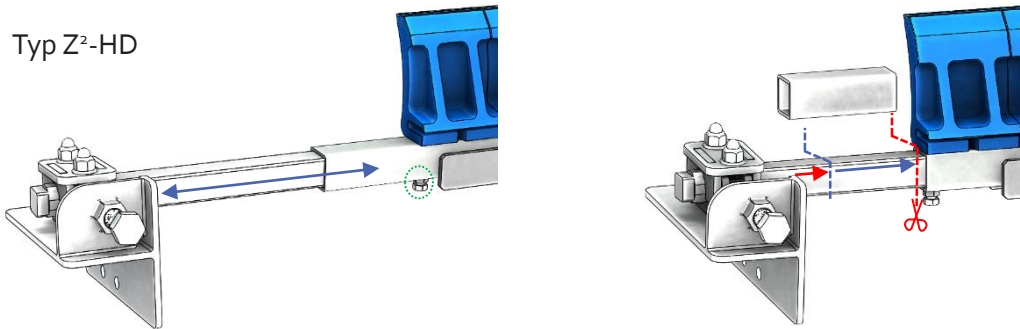

BT / BW / BB ≥ 1600

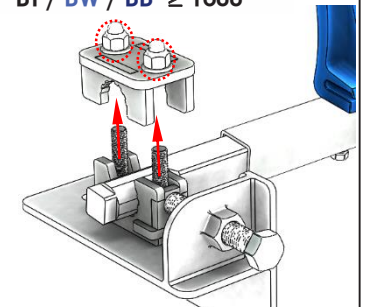

Réglage étape par étape / Adjustment step-by-step / Einstellung Schritt für Schritt

<p>1</p>	<p>2</p>	<p>3</p>	<p>4</p>
<p>Fixer cornière, ajuster EA + faire une marque Attach bracket, adjust EA + make a mark Winkel befestigen + EA einstellen + markieren</p>	<p>Reculer palier et lame Back-off bearing and blade Schaber und Achshalter rückwärts fahren</p>	<p>Tourner lame sur le tambour, puis bloquer axe Turn blade against drum and lock the shaft Schaber gegen Tommel drehen und Achsen verriegeln</p>	<p>Pousser palier jusqu'à EA correct, vérifier pression. Bloquer tout Push up to good EA, check pressure. Lock all Schieben bis korrekten EA, Druck überprüfen, alles verriegeln</p>

Mise en pression / Pressurization / Druck Einstellung



Pression insuffisante
Insufficient pressure
Druck unzureichend

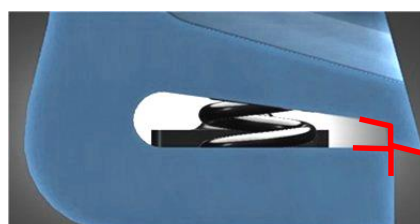

Bonne pression
Correct pressure
Druck in Ordnung

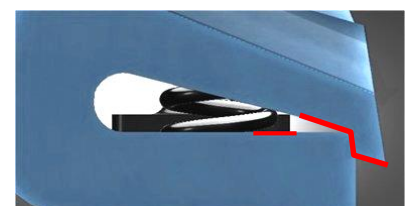

Pression trop forte
Pressure too high
Druck zu stark

Instructions/Anleitung

Typ Z²

Typ Z²-HD

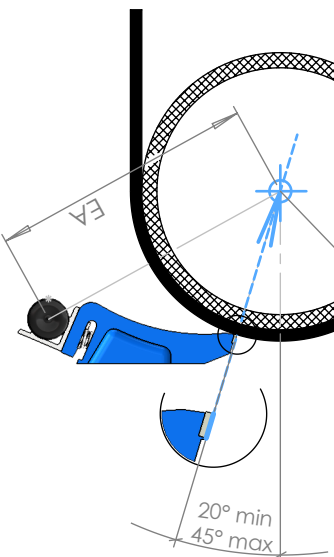
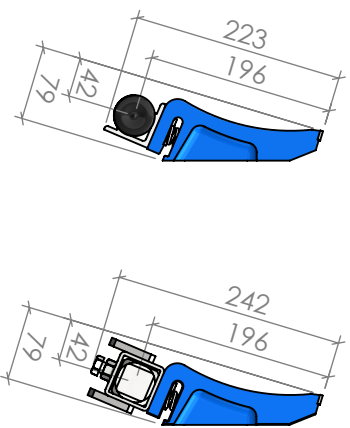

$$EA = \sqrt{(RT+42)^2 + 38410}$$

RT	100	125	150	175	200	225	250	275	300	325
EA	243	258	275	293	312	332	352	373	395	417
RT	350	375	400	425	450	475	500	525	550	575
EA	439	461	484	507	530	553	577	600	624	648

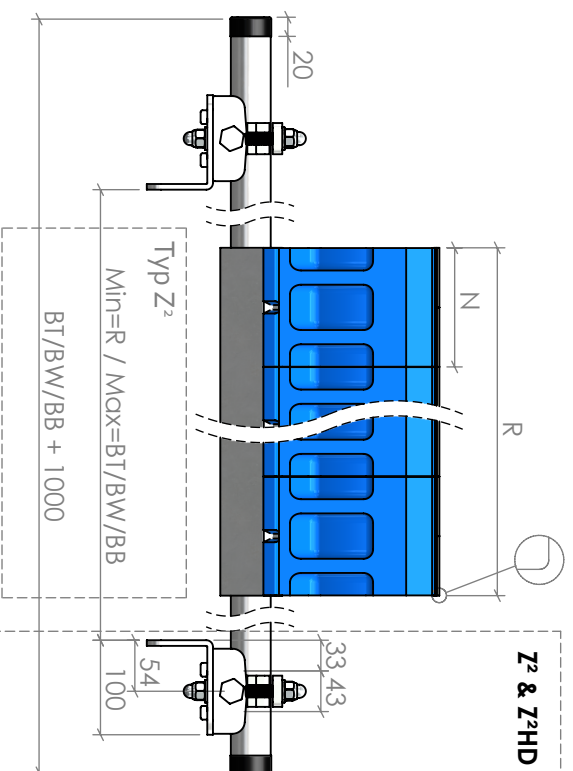

Z² & Z²HD : BT/BW/BB < 1600

Z²HD : BT/BW/BB ≥ 1600

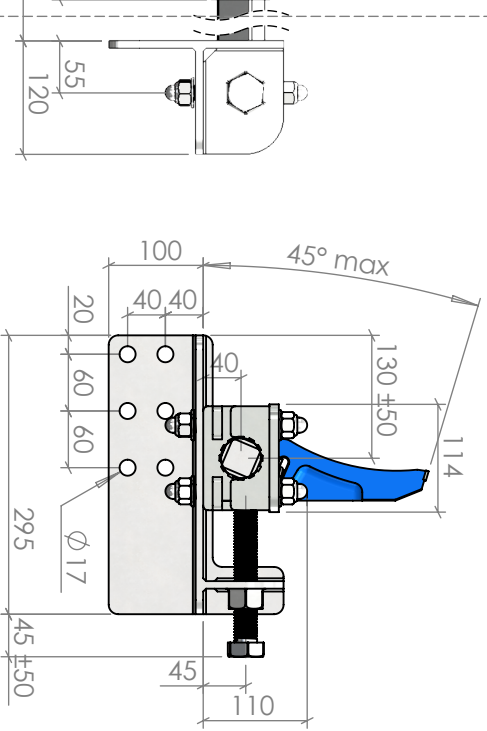
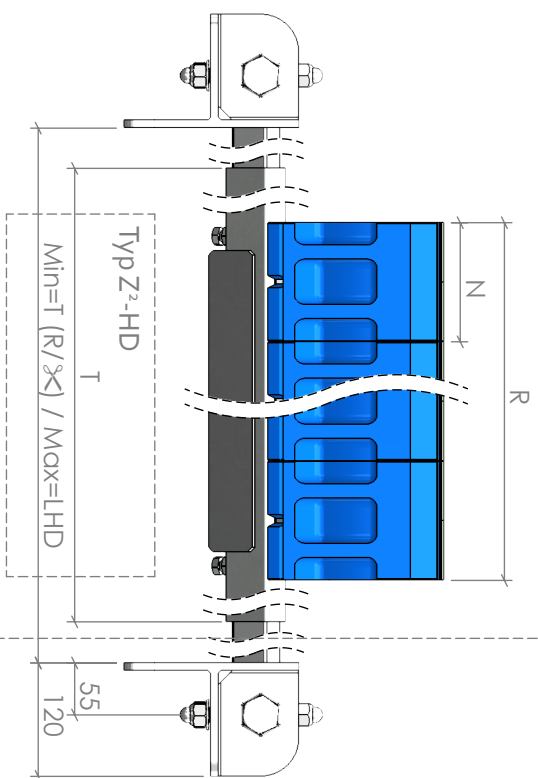
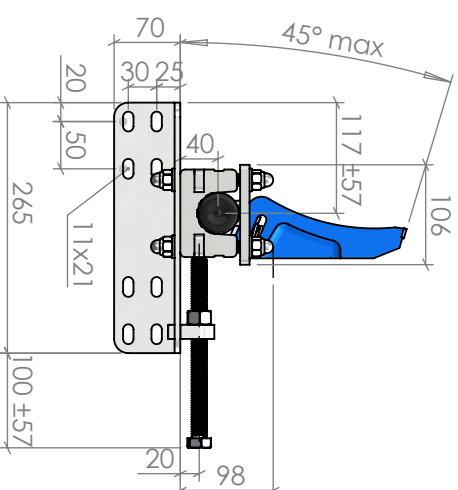

Vapeur/Steam/ Dampf

Typ Z² / Z²-HD

T°C min/max	-10	+50
pH min/max	3	11



www.wanggo.ch
WANGGO
 TECHNIK

Format A4
 Echelle 1:8

BT/BW/BB	400	500	650	800	1001	1002	1200	1401	1402	1600	1801	1802	2001	2002
N=126	3	4	5	6	7	8	9	10	11	12	13	14	15	16
R	378	504	630	756	882	1008	1134	1260	1386	1512	1638	1764	1890	2016
LHD					1745	1745	1945	2145	2145	2370	2970	2970	3170	3170
T	500	650	800	1000	1000	1200	1400	1600	1600	1800	2000	2000	2200	2200

1 2 3 4 5 6